

1. Light Body
2. Rubber Strap x 2  
(for 22.2~31.8mm Handlebar)

#### MODE

GB



Constant



Blinking

#### MOUNT ON HANDLEBAR

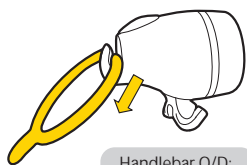

Handlebar O/D:  
22.2 - 31.8mm

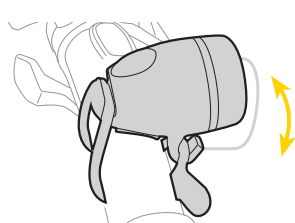

#### CHANGING BATTERY

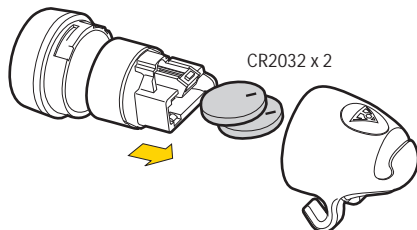
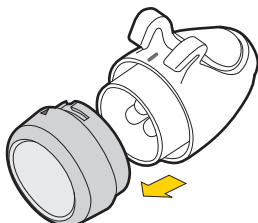

CR2032 x 2

#### ⚠ WARNING

1. Make sure rubber strap is fastened on WhiteLite II properly before riding.
2. Although light body is waterproof never intentionally submerge it under water.
3. For ultimate safety, the WhiteLite II should be used in conjunction with a specific night riding light.
4. In addition to its brightness, the beam is widely diffused. In case you need to use this light on public roads, be sure to adjust the angle downward so as not to blind oncoming traffic.



#### SPARE PARTS

Rubber Strap



Art No. TMS-sp06

CR2032 Battery



Art No. TMS-SP86

#### SPECIFICATIONS

Function: Constant/ blinking

Bulb: 3 LED.

Battery: Lithium Battery "CR2032" x 2 pcs

Burn Time (approx): 60 hours (constant use)

Weight: 24 grams (light only)

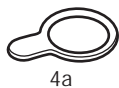

4a



4b

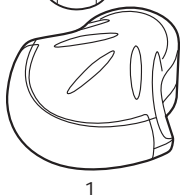

1

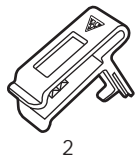

2

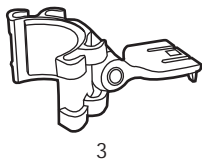

3

1. Light Body
2. Clip (for Topeak wedge and trunk bags)
3. Clamp (for seatpost / seatstay)
- 4a. Rubber Strap (for seatstay)
- 4b. Rubber Strap (for seatpost)

#### MODE



Constant



Blinking

#### MOUNTING FOR TOPEAK WEDGE AND TRUNK BAGS

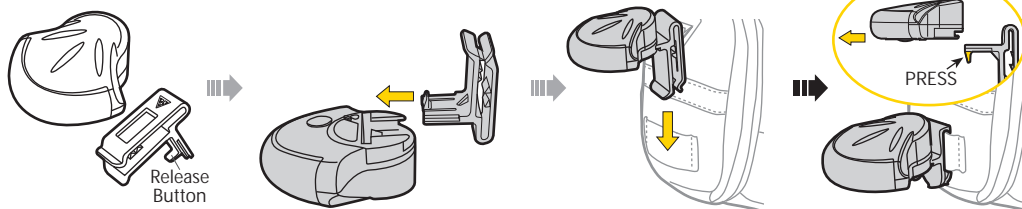

#### MOUNTING FOR SEATPOST/SEATSTAY

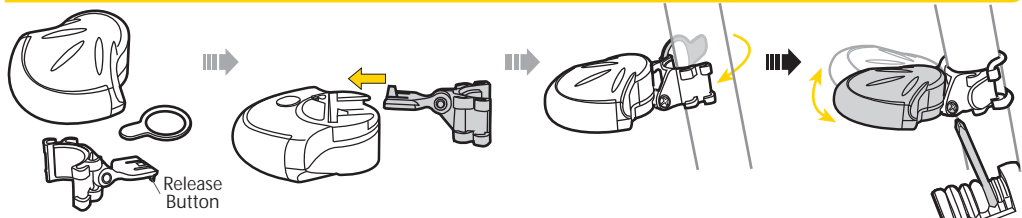

#### CHANGING BATTERY

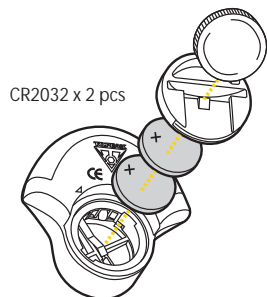

CR2032 x 2 pcs

#### SPARE PARTS

Rubber Strap



Art No. TMS-SP06

CR2032 Battery



Art No. TMS-SP86

#### SPECIFICATIONS

Function: blinking and constant  
 Bulb: 4 Red L.E.D.  
 Battery: Lithium Battery  
 "CR2032" x 2 pcs  
 Burn Time: 60 hours (constant use)  
 Weight: 20 grams (light only)

#### WARNING

Although light body is water-resistant (under normal weather conditions of rain, etc.) never intentionally submerge it under water.

#### NOTE



Close



Open

#### WARRANTY

1-year Warranty: All mechanical components against manufacturer defects only. Batteries are not covered under any implied warranty. Warranty Claim Requirements

To obtain warranty service, you must have your original sales receipt. Items returned without a sales receipt will assume that the warranty begins on the date of manufacture. All warranties will be void if the product is damaged due to user crash, abuse, system alteration, modification, or used in any way not intended as described in this manual.

\* The specifications and design are subject to change without notice.

Topeak products are available only from professional bicycle shops. Please contact your nearest Topeak authorized bicycle dealer for any questions.

For customers in the USA, call: 1-800-250-3068

Website: [www.topeak.com](http://www.topeak.com)

